

DELEGATED ITEM

Proposed Prohibition of Waiting and Bus Stop Clearway Order – Dobcross New Road, Dobcross

Report to Executive Director, Commercial Services

Portfolio Holder : Councillor D Hibbert – Environment and Housing

Officer Contact : Andrew Cowell
Ext. 1963

Purpose of Report

The purpose of this report is to consider a request for parking restrictions to be introduced on Dobcross New Road near to the junction of Nicker Brow.

Recommendation

It is recommended that a Prohibition of Waiting Order as detailed in the schedule at the end of this report, be approved for implementation.

Proposed Prohibition of Waiting and Bus Stop Clearway Order – Dobcross New Road, Dobcross

1 Background

- 1.1 A request was received from a local resident for the Highway Authority to investigate concerns over the effect parked vehicles have on vehicle movements in the vicinity of Dobcross New Road and Nicker Brow, Dobcross. It is reported that parked vehicles affect visibility for motorists exiting Nicker Brow onto Dobcross New Road and that parked vehicles also cause general congestion in the area.

2 Observations

- 2.1 An Officer met with the resident and a local Parish Councillor and witnessed the reported problems on site. Parked vehicles on Dobcross New Road restrict visibility for motorists exiting Nicker Brow and also prevent the free flow of two-way traffic along Dobcross New Road. Occasionally, queuing traffic extends to the roundabout at High Street which adversely affects traffic movements at the roundabout.
- 2.2 There are currently existing restrictions in place on Dobcross New Road from the junction of High Street for a distance of 30 metres in a westerly direction. There is a bus stop located on each side of Dobcross New Road at a point approximately 35 metres west of High Street.
- 2.3 Officers have checked the Police Injury Accident Database and there are no recorded injury accidents at this location.

3 Justification

- 3.1 Officers believe that visibility can be improved by extending the existing parking restrictions on the north side of Dobcross New Road up to the junction of Nicker Brow. This will improve the safety for motorists exiting Nicker Brow. On the south side it is proposed to extend the restrictions to a similar length which will maintain the unobstructed free flow of two-way traffic along Dobcross New Road and prevent queuing traffic from affecting traffic movements at the roundabout on High Street.
- 3.2 In addition to the prohibition of waiting restrictions, it is proposed to introduce two bus stop clearway orders to prevent vehicles stopping at the two bus stops. This will ensure that buses can access the stop and passengers can board and alight the bus safely.

3.3 It is not anticipated that the proposed restrictions would affect local residents as they utilise on-street parking areas to the west of Nicker Brow. It is reported that the parking activity to the east of Nicker Brow is generated by visitors to the Brownhill Centre, located nearby.

4 **Options/Alternatives**

4.1 Option 1: To approve the recommendation.

4.2 Option 2: Not to approve the recommendation.

5 **Preferred Option**

5.1 The preferred option to approve is Option 1.

6 **Consultations**

6.1 G.M.P. View - The Chief Constable has been consulted and has no comment on this proposal.

6.2 T.f.G.M. View - The Director General has been consulted and supports this proposal.

6.3 G.M. Fire Service View - The County Fire Officer has been consulted and has no comment on this proposal.

6.4 N.W. Ambulance Service View - The County Ambulance Officer has been consulted and has no comment on this proposal.

7 **Comments Of Saddleworth North Ward Councillors**

7.1 The Ward Councillors have been consulted and Councillor Harkness has responded stating the following:

I have had three objections to the proposals from residents and DVC committee members. All three highlight the possibility of increased speed of traffic on the road as a result (one suggests that the parked vehicles are a good traffic calming measure). Two of the objections related to parking problems that already exist being exacerbated. I have received an objection from a local resident and business and the comments are indicated below:

Further parking restrictions as proposed would NOT be a good idea because

- Nicker Brow is a pedestrian lane, so I don't understand the question anyway but I can only presume the concern comes from motorists coming out of Lowerfields (a cul-de-sac of **six of seven houses** at the end of Nicker Brow) - hardly a busy junction!!!! How many times a day do cars come out from there onto Dobcross New Road? Would the disruption for the many justify the heavy handed proposed restrictions?

- the village is a place where people live - it is not merely a rat run for motorists
- cars are a fact of life and need to be parked somewhere (restrictions would only displace the problem, not remove cars from our roads)
- parked cars are a traffic calming safety measure. Car travelling speeds would greatly increase in the absence of parked cars and the risk of traffic accidents would increase

Perhaps other options could be explored for the very small number of motorists coming on to Dobcross New Road from Lowerfields, such as a mirror opposite the junction.

7.2 **Response to Councillor Comments**

Unfortunately it would not be possible to install a traffic mirror in this location as they cannot be authorised on roads subject to a 30mph speed limit.

Parked vehicles can often regulate vehicle speeds. However, in this instance the parking activity is close to a junction and therefore the effect in this location would be negligible.

With regards to residents concerns over parking, the Council were informed that vehicles parked between Nicker Brow and the roundabout were associated with the Brownhill Centre. It was presumed that residents without off-street parking facilities utilise the area to the west of Nicker Brow and that they would be unaffected by the proposal. Officers have inspected the location twice during the evening time and found that no vehicles were parked in the area to the east of Nicker Brow, where the restrictions are proposed. Therefore, it is likely that residents would not be affected by the proposal and Officers would support the introduction of the restrictions as proposed.

It should be noted that the proposal also seeks to address a number of issues including vehicles obstructing the two bus stops. Therefore, a second option to introduce the two bus stop clearways only, should be considered by the District Executive.

8 **Financial Implications**

8.1 <>

9 **Legal Services' Comments**

9.1 <>

10 **Cooperative Agenda**

10.1 In respect of Dobcross New Road, there are no Co-operative issues or opportunities arising and the proposals are in line with the Council's Ethical Framework.

11 **Human Resources Comments**

11.1 None.

12 **Risk Assessments**

12.1 None.

13 **IT Implications**

13.1 None.

14 **Property Implications**

14.1 None.

15 **Procurement Implications**

15.1 None.

16 **Environmental And Health & Safety Implications**

16.1 Energy – Nil.

16.2 Transport – The proposal will improve the safety in this area for all road users.

16.3 Pollution – Nil.

16.4 Consumption and Use of Resources – In accordance with current specifications.

16.5 Built Environment – Minor alteration to the visual appearance of the area.

16.6 Natural Environment – Nil.

16.7 Health and Safety – The introduction of waiting restrictions will remove obstructive parking and create a safer environment for vehicles exiting Nicker Brow and travelling along Dobcross New Road.

17 **Equality, Community Cohesion and Crime Implications**

17.1 The implementation of parking restrictions will ease local residents concerns about road safety.

18 **Equality Impact Assessment Completed?**

18.1 No.

19 **Key Decision**

19.1 No.

20 **Forward Plan Reference**

20.1 Not applicable.

21 **Background Papers**

21.1 The following is a list of background papers on which this report is based in accordance with the requirements of Section 100(1) of the Local Government Act 1972. It does not include documents which would disclose exempt or confidential information as defined by the Act :

File Ref : TM3/812
Name of File : Traffic Regulation Orders
Officer Name : Mr D Dalrymple
Contact No : 0161 770 5243

22 **Proposal**

22.1 It is proposed that prohibitive waiting and stopping restrictions be introduced on Dobcross New Road in accordance with the following schedule.

Schedule

Drawing Number 47/A4/1340/1

Oldham Borough Council (Saddleworth Area) Consolidation Order 2003
As amended by the Oldham Borough Council (Variation of the Oldham Area, Lees Area, Chadderton Area, Failsworth Area, Royton Area, Crompton Area and Saddleworth Area Consolidation Orders) Minor Order 2004

Delete from Part I Schedule 1

Item No	Length of Road	Duration	Exemptions	No Loading
(S27)	<u>Dobcross New Road</u> (Both sides) From its junction with High Street for a distance of 30 metres in a westerly direction	At any time	A, B1, B2, B3, B4, B5, C, F, G, K4, N	

**Insert in Part I Schedule 1
Prohibition of Waiting**

Item No	Length of Road	Duration	Exemptions	No Loading
	<u>Dobcross New Road, Dobcross</u> (North side) From its junction with High Street to a point 5 metres west of its junction with Nicker Brow	At any time	A, B1, B3, B4, C, E, K3	
	<u>Dobcross New Road, Dobcross</u> (South side) From its junction with High Street for a distance of 74 metres in a westerly direction	At any time	A, B1, B3, B4, C, E, K3	

Proposed Bus Stop Clearway (Prohibition of Stopping) (No TRO Required)

Location	Description	Hours of Operation
<u>Dobcross New Road, Dobcross</u>	(North side) From a point 36 metres west of its junction with High Street for a distance of 23 metres in a westerly direction	24 hours
<u>Dobcross New Road, Dobcross</u>	(South side) From a point 13 metres west of its junction with High Street for a distance of 23 metres in a westerly direction	24 hours

Signed _____ Assistant Executive Director Corporate Property	Dated _____
Signed _____ Cabinet Member, Environment and Housing	Dated _____

Report Tracking	
Where	When
EMT	
Leadership	
Joint Leadership	
Overview & Scrutiny	

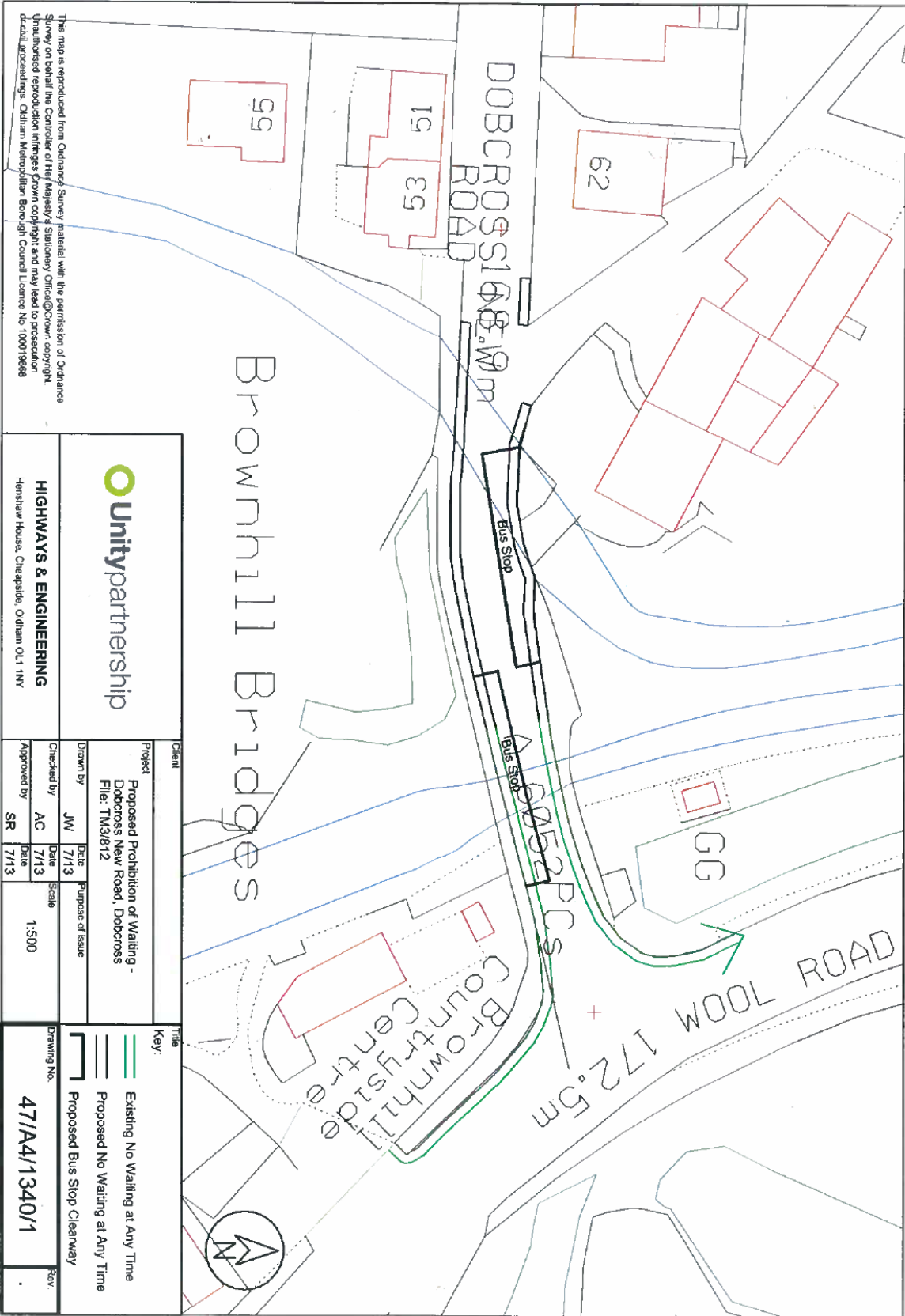

This map is reproduced from Ordnance Survey material with the permission of Ordnance Survey on behalf of the Controller of Her Majesty's Stationery Office. Crown copyright. Unauthorised reproduction infringes Crown copyright and may lead to prosecution or civil proceedings. Ordnance Survey, Ordnance Survey Licence No. 100019666

		HIGHWAYS & ENGINEERING Henlaw House, Cheapside, Oulham OL1 1HW	
Client	Project	Drawn by	Checked by
	Proposed Prohibition of Waiting - Dobcross New Road, Dobcross File: TM31612	JW	AC
		Date 7/13	Date 7/13
		Purpose of issue	Scale
			1:500
		Approved by	Date
		SR	7/13
Title	Key:	Drawing No.	Rev.
	<ul style="list-style-type: none"> — Existing No Waiting at Any Time — Proposed No Waiting at Any Time Proposed Bus Stop Clearway 	47/A4/1340/1	.